

Malleable Iron Fittings



Threads: Threads are in accordance to ISO7-1. All male threads are BSPT and female threads are BSPP.

Materials: Whiteheart malleable EN-GJMW-400-5 cast iron, grade W40-05 according to ISO5922/DIN-1692, and tested in accordance to EN 10242

Media: Suitable for the flow of water, steam, gas or other non aggressive media.

Surface Finishing:

Two types are available:

Black: With an anti-corrosive varnish to protect against rust and after installation prior to plant conditioning.

Galvanised: According to EN 10242, zinc coating weight relative to surface exceeds 500 g/m² (average layer thickness 70 micron).



Maximum Working Pressure:

25 bar @ -20°C to +120°C
20 bar @ +300°C

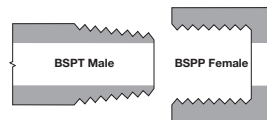

Plug, Hollow Beaded (290)

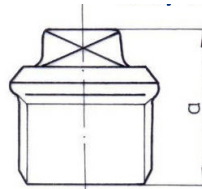
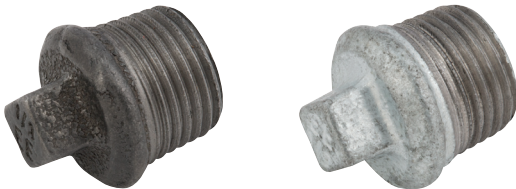

Black, BSPT	
Part Number	Thread
EE-MI290-14N	1/4"
EE-MI290-38N	3/8"
EE-MI290-12N	1/2"
EE-MI290-34N	3/4"
EE-MI290-1N	1"
EE-MI290-114N	1.1/4"
EE-MI290-112N	1.1/2"
EE-MI290-2N	2"
EE-MI290-212N	2.1/2"
EE-MI290-3N	3"
EE-MI290-4N	4"

Galvanised, BSPT	
Part Number	Thread
EE-MI290-14	1/4"
EE-MI290-38	3/8"
EE-MI290-12	1/2"
EE-MI290-34	3/4"
EE-MI290-1	1"
EE-MI290-114	1.1/4"
EE-MI290-112	1.1/2"
EE-MI290-2	2"
EE-MI290-212	2.1/2"
EE-MI290-3	3"
EE-MI290-4	4"

Dimension[inch]	Weight of carton [kg]		Quantity in carton [pc.]	Dimension a [mm]
	black	galv		
1/4	11,5	13,5	500	25
3/8	15,3	15,8	450	24
1/2	18,6	18,9	350	28
3/4	15	15,6	200	32
1	18	18,8	150	36
1 1/4	18,9	19,1	100	39
1 1/2	17	17,4	80	41
2	22,9	23,5	55	48
2 1/2	21,2	21,9	30	54
3	16,6	17	20	60
4	18,8	19,5	10	70

Cap, Hexagonal (300)

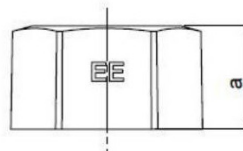

Black, BSPP	
Part Number	Thread
EE-MI300-14N	1/4"
EE-MI300-38N	3/8"
EE-MI300-12N	1/2"
EE-MI300-34N	3/4"
EE-MI300-1N	1"
EE-MI300-114N	1.1/4"
EE-MI300-112N	1.1/2"
EE-MI300-2N	2"
EE-MI300-212N	2.1/2"
EE-MI300-3N	3"
EE-MI300-4N	4"

Galvanised, BSPP	
Part Number	Thread
EE-MI300-14	1/4"
EE-MI300-38	3/8"
EE-MI300-12	1/2"
EE-MI300-34	3/4"
EE-MI300-1	1"
EE-MI300-114	1.1/4"
EE-MI300-112	1.1/2"
EE-MI300-2	2"
EE-MI300-212	2.1/2"
EE-MI300-3	3"
EE-MI300-4	4"

Dimension [inch]	Weight of carton [kg]		Quantity in carton [pc.]	Dimension a [mm]
	black	galv		
1/4	9,6	10	400	15
3/8	9,9	10,2	300	17
1/2	13,8	14,3	250	22,5
3/4	16,4	17,2	200	25
1	20,7	21,3	150	27,5
1 1/4	20,9	21,6	100	30
1 1/2	16,2	16,9	70	30
2	21,5	22,4	45	35,5
2 1/2	19,1	19,4	30	36,5
3	23	23,9	24	39,5
4	19,5	19,9	10	46,5

Female Equal Union, Taper seat (340)

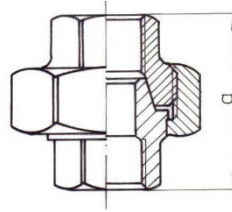

Black, BSPP	
Part Number	Thread
EE-MI340-38N	3/8"
EE-MI340-12N	1/2"
EE-MI340-34N	3/4"
EE-MI340-1N	1"
EE-MI340-114N	1.1/4"
EE-MI340-112N	1.1/2"
EE-MI340-2N	2"
EE-MI340-212N	2.1/2"
EE-MI340-3N	3"

Galvanised, BSPP	
Part Number	Thread
EE-MI340-38	3/8"
EE-MI340-12	1/2"
EE-MI340-34	3/4"
EE-MI340-1	1"
EE-MI340-114	1.1/4"
EE-MI340-112	1.1/2"
EE-MI340-2	2"
EE-MI340-212	2.1/2"
EE-MI340-3	3"
EE-MI340-4	4"

Dimension [inch]	Weight of carton [kg]		Quantity in carton [pc.]	Dimension a [mm]
	black	galv		
3/8	16	16,4	120	45
1/2	18,8	19,4	80	48
3/4	17	17,6	60	52
1	20,6	21,4	60	58
1 1/4	19,8	20,4	35	65
1 1/2	19,1	19,8	25	70
2	23	23,5	20	78
2 1/2	19	19,4	10	85
3	22,3	23,1	8	95
4	20,2	20,4	4	110

Backnuts (310)

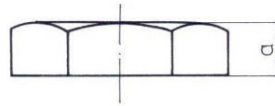

Black, BSPP	
Part Number	Thread
EE-MI310-14N	1/4"
EE-MI310-38N	3/8"
EE-MI310-12N	1/2"
EE-MI310-34N	3/4"
EE-MI310-1N	1"
EE-MI310-114N	1.1/4"
EE-MI310-112N	1.1/2"
EE-MI310-2N	2"
EE-MI310-212N	2.1/2"
EE-MI310-3N	3"

Galvanised, BSPP	
Part Number	Thread
EE-MI310-14	1/4"
EE-MI310-38	3/8"
EE-MI310-12	1/2"
EE-MI310-34	3/4"
EE-MI310-1	1"
EE-MI310-114	1.1/4"
EE-MI310-112	1.1/2"
EE-MI310-2	2"
EE-MI310-212	2.1/2"
EE-MI310-3	3"

Dimension [inch]	Weight of carton [kg]		Quantity in carton [pc.]	Dimension a [mm]
	black	galv		
1/4	7,2	7,8	600	6
3/8	11	11,5	500	7
1/2	12	12,4	400	8
3/4	10,2	10,8	300	9
1	18,9	19,8	300	10
1 1/4	18,8	19,6	200	11
1 1/2	22	23	200	12
2	18,8	19,2	100	13
2 1/2	21,8	22,2	50	16
3	19	20,1	40	19
4	18,4	19,4	20	22

Cap, Rounded (301)



Black, BSPP	
Part Number	Thread
EE-MI301-38N	3/8"
EE-MI301-12N	1/2"
EE-MI301-34N	3/4"
EE-MI301-1N	1"
EE-MI301-112N	1.1/2"
EE-MI301-2N	2"

Galvanised, BSPP	
Part Number	Thread
EE-MI301-38	3/8"
EE-MI301-12	1/2"
EE-MI301-34	3/4"
EE-MI301-1	1"
EE-MI301-112	1.1/2"
EE-MI301-2	2"